

**GENERALLUX STAR, HYPER HEAT Mini split Heat Pump Inverter, OUTDOOR UNIT, Parts Diagram**

**Outdoor Unit Model:** AST-18UW3SBBTU01

**Nominal capacity:** 18000BTU

**Power supply:** 208-230V, 1 Ph, 60 Hz

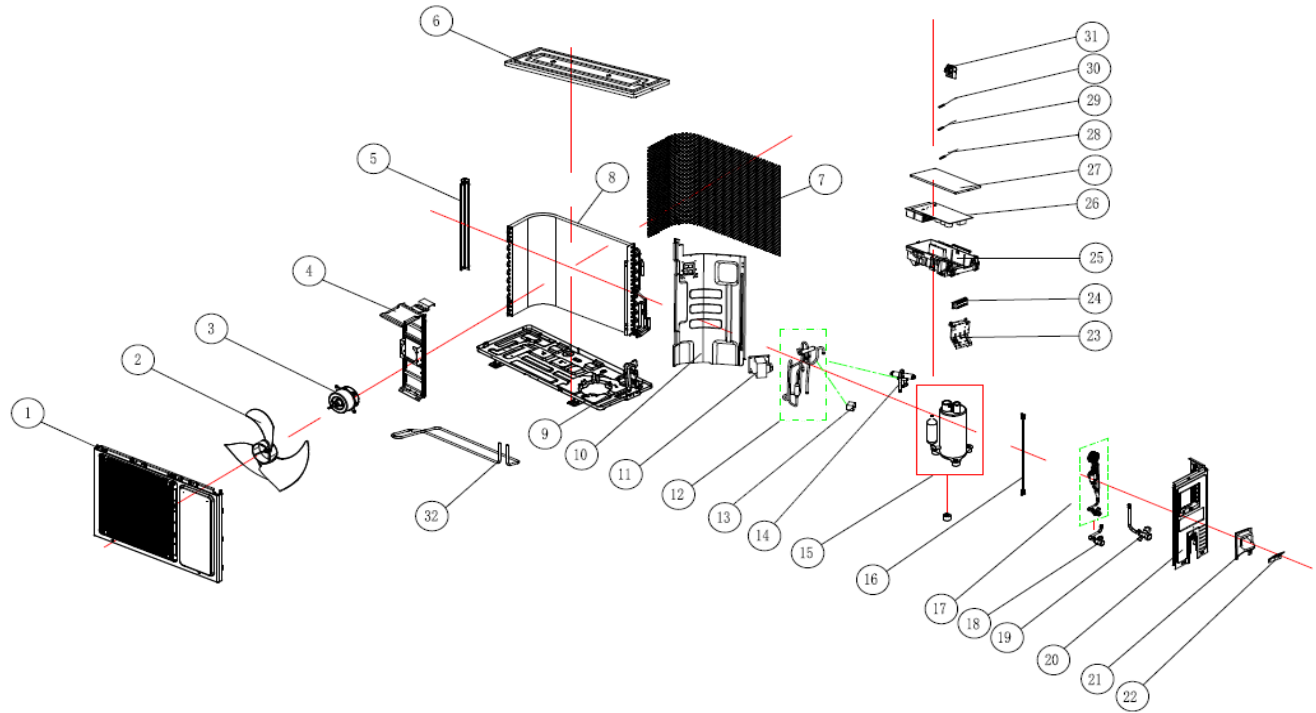

| SR | PART CODE | DESCRIPTION                         |
|----|-----------|-------------------------------------|
| 2  | 1841783   | propeller fan blade                 |
| 3  | 1892229   | DC motor                            |
| 8  | 2305584   | Condenser assembly                  |
| 11 | NA        | PFC inductance                      |
| 12 | 2247092   | 4-way valve assembly                |
| 13 | 1511783   | Four-way valve coil                 |
| 14 | 1408045   | 4-way valve                         |
| 15 | 2244502   | Inverter compressor                 |
| 17 | 2266156   | Electronic expansion valve assembly |
| 18 | 1405371   | 1/4 2-way valve                     |
| 19 | 2269120   | valve assembly                      |
| 26 | 2245818   | Controller Component                |
| 28 | 1562104   | Temperature sensor                  |
| 29 | 1822633   | Temperature sensor                  |
| 30 | 1822634   | Temperature sensor                  |
| 31 | 1546721   | sensor mounting plate               |
| 32 | 1854710   | Tube electric heater                |
|    |           |                                     |
|    |           |                                     |
|    |           |                                     |
|    |           |                                     |