

GENERALLUX STAR, HYPER HEAT Mini split Heat Pump Inverter, OUTDOOR UNIT, Parts Diagram

Outdoor Unit Model: AST-12UW3SXETU02

Nominal capacity: 12000BTU

Power supply: 208-230V, 1 Ph, 60 Hz

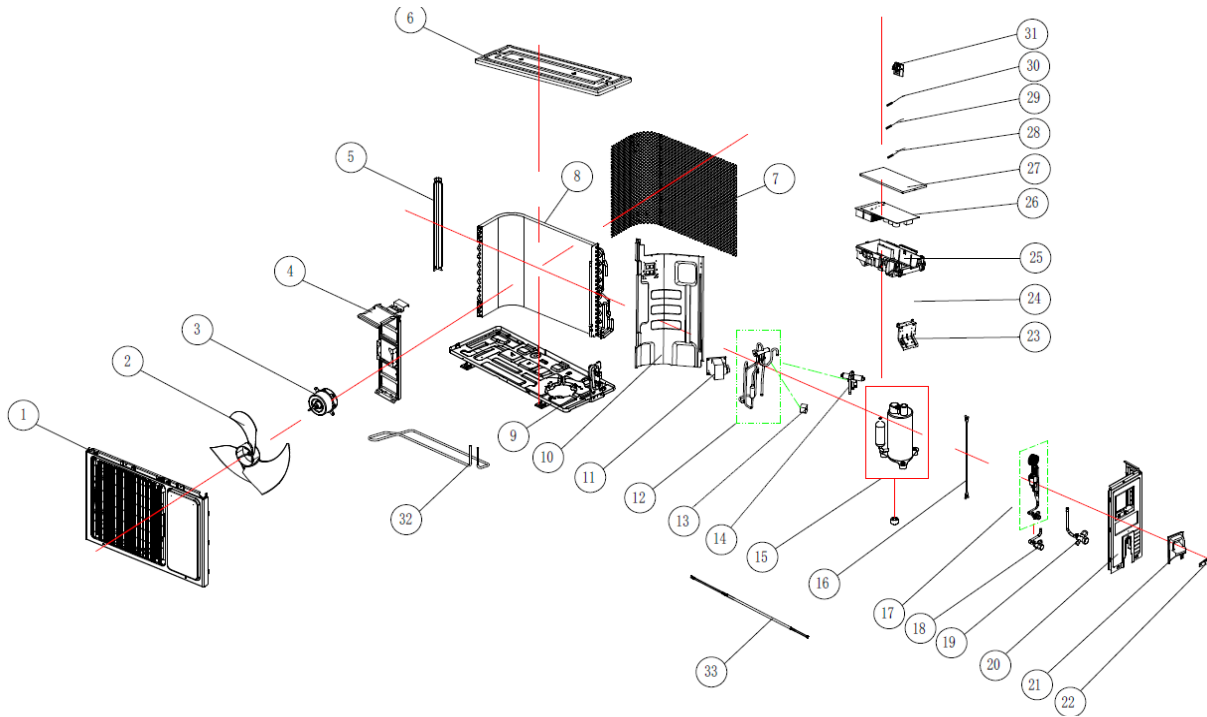

SR	PART CODE	DESCRIPTION
2	1556766	propeller fan blade
3	2023374	DC motor
6	1865978	top plate
8	2315444	Condenser assembly
9	1903259	base holder part
10	1856146	clapboard
11	NA	PFC inductance
12	2262732	4-way reversing valve assembly
13	1511783	Four-way valve coil
14	1258654	4-way reversing valve
19	1335015	3/8" inch 3-way valve
15	2246207	compressor parts
16	1938339	Connecting wire for compressor
17	2090336	Electronic expansion valve assembly
18	1405371	1/4" inch 2-way valve
26	2237068	Controller Component
28	1822633	Temperature sensor
29	1822634	Temperature sensor
30	1831029	Temperature sensor
31	1546721	temperature sensor seat
32	1854766	tube type electric heater