

**GENERALLUX STAR Mini split Heat Pump Inverter, OUTDOOR UNIT, Parts Diagram**

**Outdoor Unit Model: AST-12UW3SXETU01**

**Nominal capacity: 12000BTU**

**Power supply: 208-230V, 1 Ph, 60 Hz**

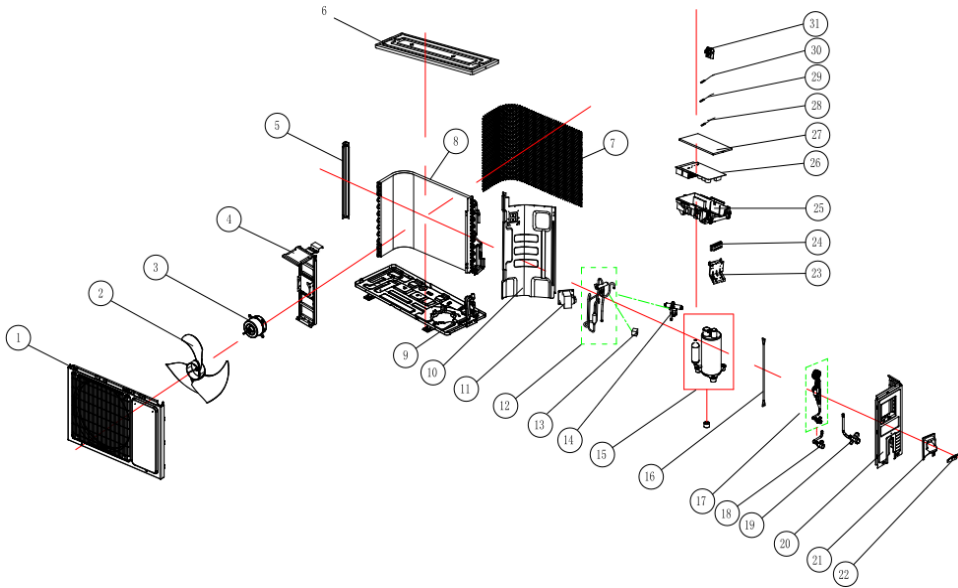

SR	PART CODE	DESCRIPTION
1	1847919	panel parts
2	1556766	propeller fan blade
3	1457759	DC motor
4	1849292	motor supporter assy
5	1846086	mounting plate
6	1846082	upper board
7	1854579	back guard
7	1854580	back guard
8	1877326	Condenser assembly
9	1851356	base holder part
10	1847982	clapboard
11	1829624	PFC inductance
12	1923524	4-way valve assembly
13	1511783	Four-way valve coil
14	1258654	4-way valve
15	1821191	Compressor
16	1822371	Compressor connect wire
17	1854557	Capillary assembly
18	1844583	1/4 2-way valve
19	1335015	3/8 3-way valve
20	1846084	right side board
21	1854040	wiring distribution cover assy
22	1854034	fixed board
23	1937153	connecting board
24	1852124	Wire terminal board
25	1951957	electric box
26	1985663	Outdoor Main Control Board Component
27	1894526	electric box cover
28	1472663	Temperature sensor
29	1511780	Temperature sensor
30	1831029	Temperature sensor
31	1546721	sensor mounting plate